

Pre-Adoption of L-5323-18A Land Use Map

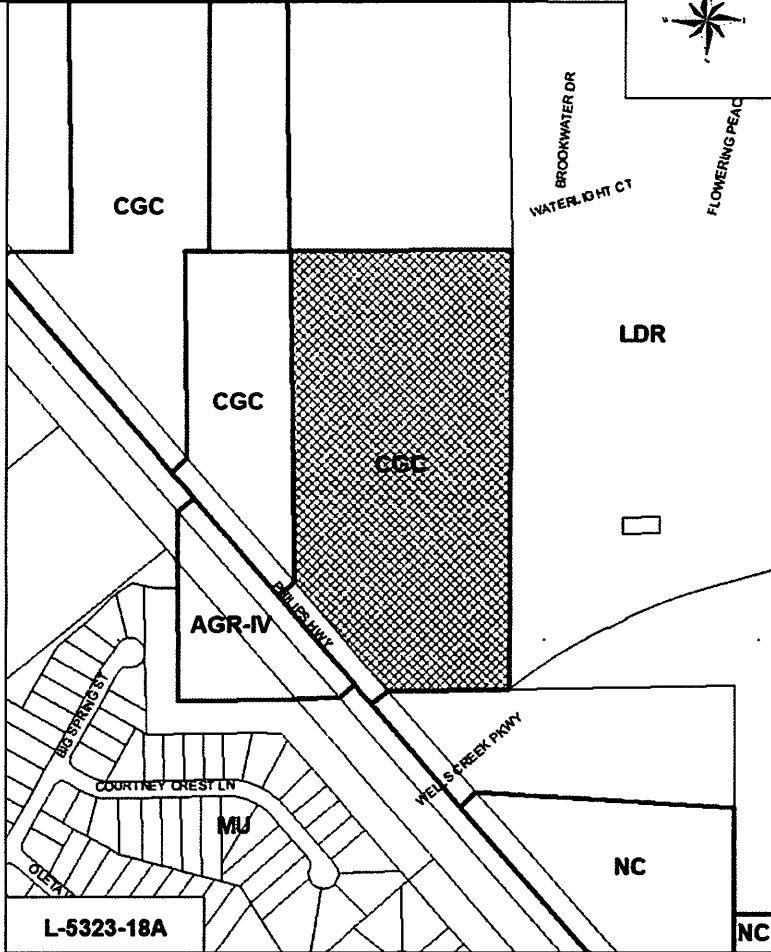

Post-Adoption of L-5323-18A Land Use Map

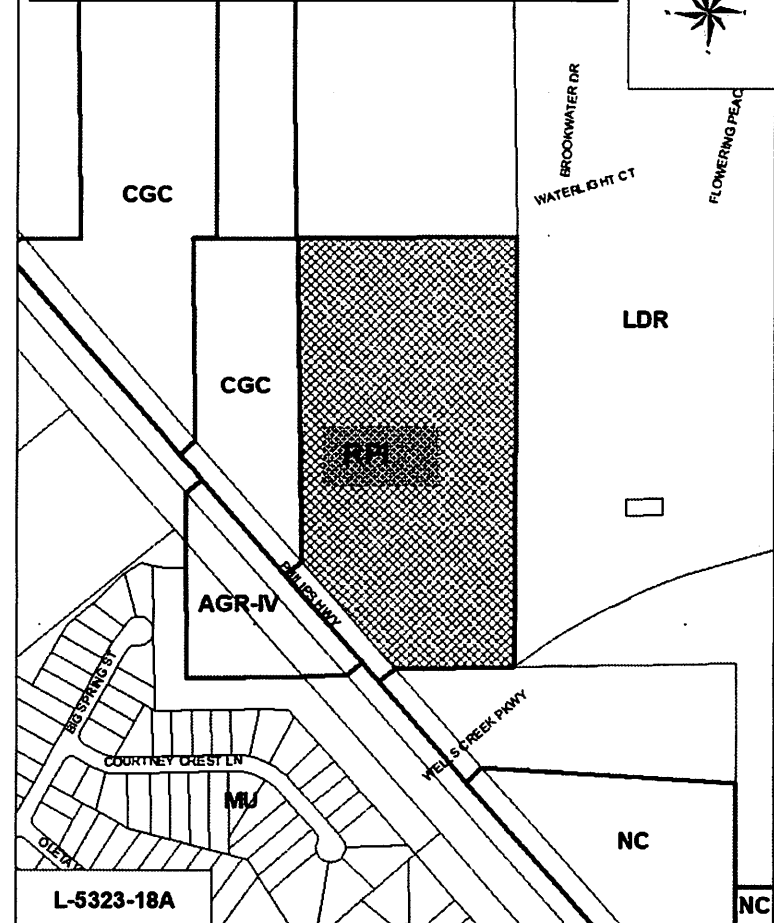

**Request for Large Scale Land Use Amendment to Future Land Use Map Series**

**From: Community/General Commercial (CGC)**

**To: Residential-Professional-Institutional (RPI)**

**Planning District: 3**

**Identification Number: L-5323-18A**

**Council District: 11**

**Exhibit 2 (Page 1 of 1)**

